

SECOND FLOOR

We Encourage.....

- Exploration
- Asking before touching
- Trying to use walking feet
- Curiosity and questions

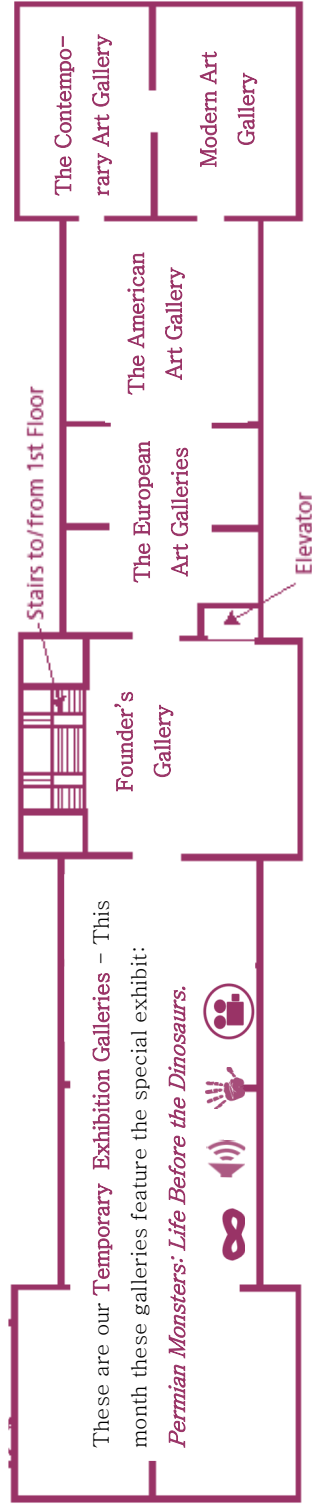

These are our Temporary Exhibition Galleries - This month these galleries feature the special exhibit: *Permian Monsters: Life Before the Dinosaurs.*

We Welcome.....

- Learners of all ages and abilities
- Kids being kids
- Fidgets and other sensory devices

Don't Forget to visit The Planetarium

- Public star shows M-F at 2., 3., and 4p.m.
- Sundays at 1, 2, 3, and 4p.m.
- Tickets available at The Museum admission desk
- Sensory kits available at The Planetarium.
- Planetarium Sensory guides also available.

Museum Sensory Map

Upcoming Sensory Friendly Events

Sensory Mornings (9 a.m. to 11 a.m.)

Monday, June 3 & Sunday, June 9 (Museum Only)

Monday, July & Sunday, July 7 (Museum Only)

Monday, August & Sunday, August (Planetarium Only)

Sensory Friendly Fireworks Show - Wednesday July 3 at 5 p.m. & 7 p.m.

Reservations Required for fireworks show

Museum Map Symbols & Meanings

Please look for these symbols on The Museum map to help you determine which galleries in The Museum are the best for you to visit. Please ask any staff member if you have any questions or need assistance.



Hands-On Component — There may be objects or activities in this gallery that your child can touch.



Scary Component — There may be an object in this gallery that your child might find scary.



Video Component — There may be a video in this gallery that might overstimulate your child.



Noise Component— There may be a noise component in this gallery that might be too loud for your child.

Sensory kits can be checked out at
The Museum admission desk for use during your visit.



GROUND FLOOR

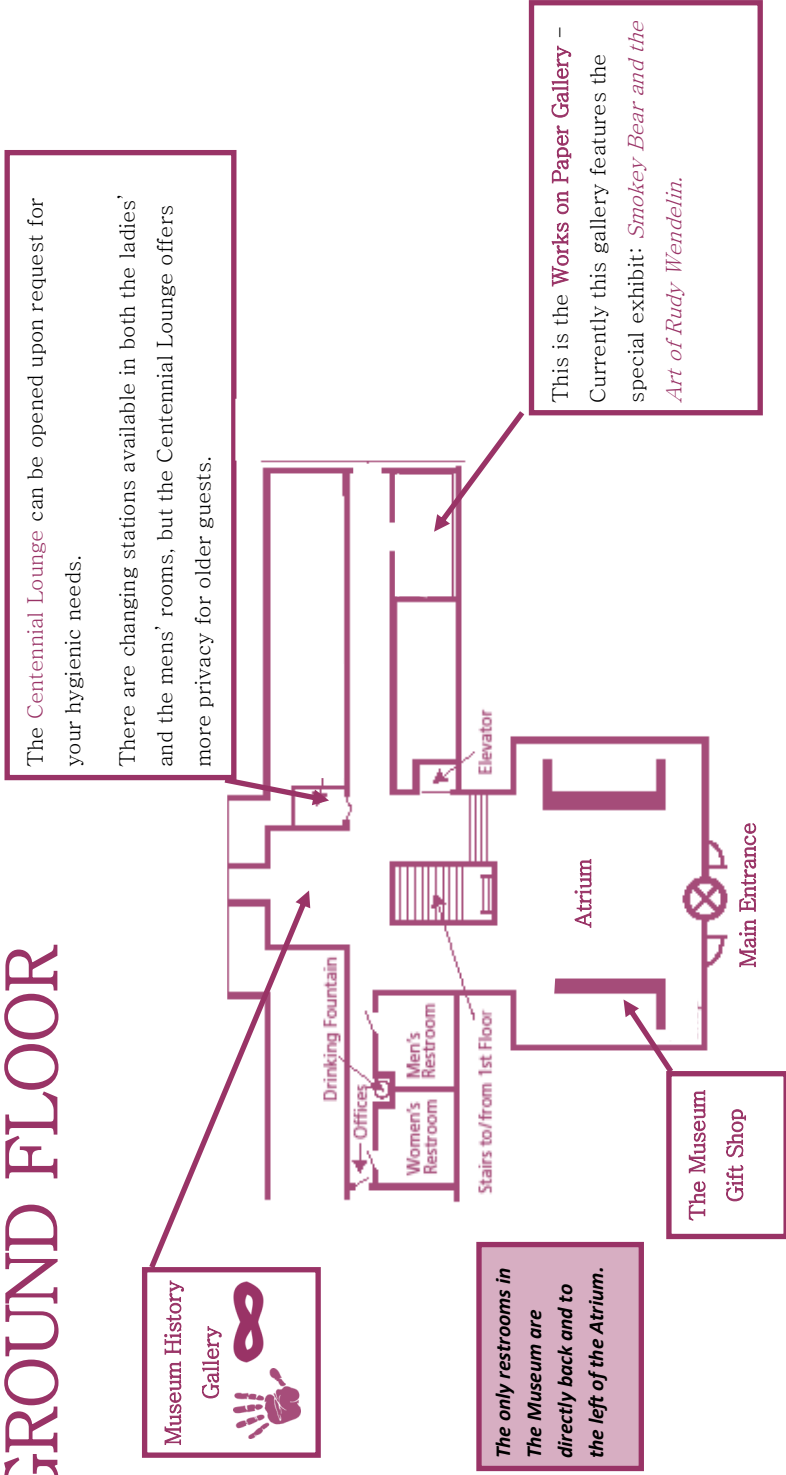

FIRST FLOOR

